

Location Map



Your  
Space  
Your  
Place

We invite you to visit us and discover the joy of living in an Eco-friendly place custom designed and inspired by nature to fulfil all your basic needs in a peaceful environment.

PROMOTERS



**AMALTAS  
INDIA LIMITED**

S-9, Sanchi Complex, opp. Board Office, Shivaji Nagar, Bhopal. INDIA  
Tel.: 0755 - 2572019, 6602553, Mob.: 7828512391-92, 9993333657

ARCHITECTS

**Vikram & Aradhana Mohile / INTERARCH,**  
Bhopal Tel: 09229169130, 9826725535

Legal Notes : In the interest of the continual development in design and quality of construction, the Developer reserves all the rights to make any changes in the scheme, including technical specifications, designs, planning and layout at any stage and all the purchasers shall abide by such changes. Changes/alterations of any nature by any of the purchasers or any association formed by them, including the elevations, exterior colour scheme of the apartments or any other change affecting the overall scheme, concept or outlook of the scheme are strictly not permitted during or after the completion of the scheme. The brochure is intended only to convey the essential design and technical features of the scheme and shall not be construed to form a part of any legal document.

Designed By : Fame Advertising, Bhopal. Ph.: 0755 - 2554202, 4221206





## Amaltas Group

**Amaltas Group** is a well known name in the field of residential and commercial real-estate. It enjoys a unique niche for its reliability and innovative concepts that has always set trends for others to follow. The Group is known for its reliability and innovative concepts, it is a professionally managed group in the real estate Industry, focusing on the customers need and satisfaction. **Amaltas Group** is committed to build long term relationship based on integrity, performance, value and client's satisfaction. The group has already built a strong pillar of popularity because of its attention and endurance to the basic needs paralleled with the luxurious desires of the customers The group was established in 1995 and has 19 year creditable track record and has delivered more than 30 successful projects.



An incredible **opportunity** to build **your home** in the most **scenic environment**.

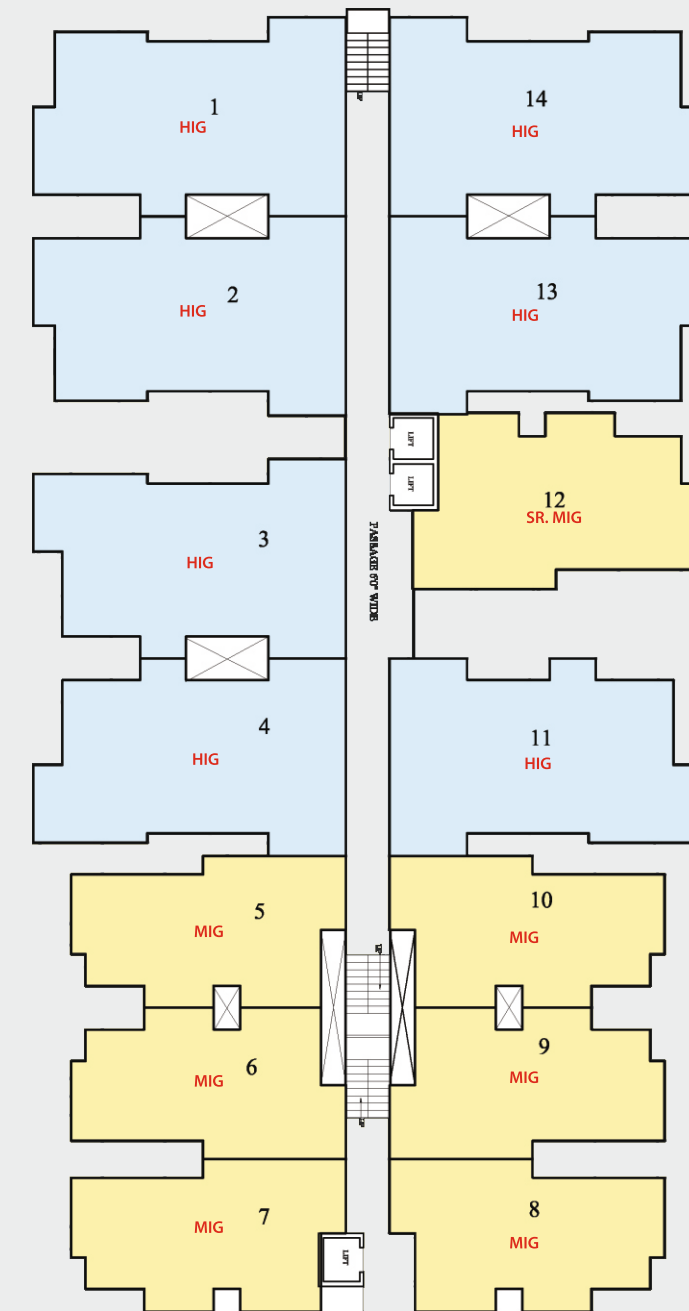

Key Plan





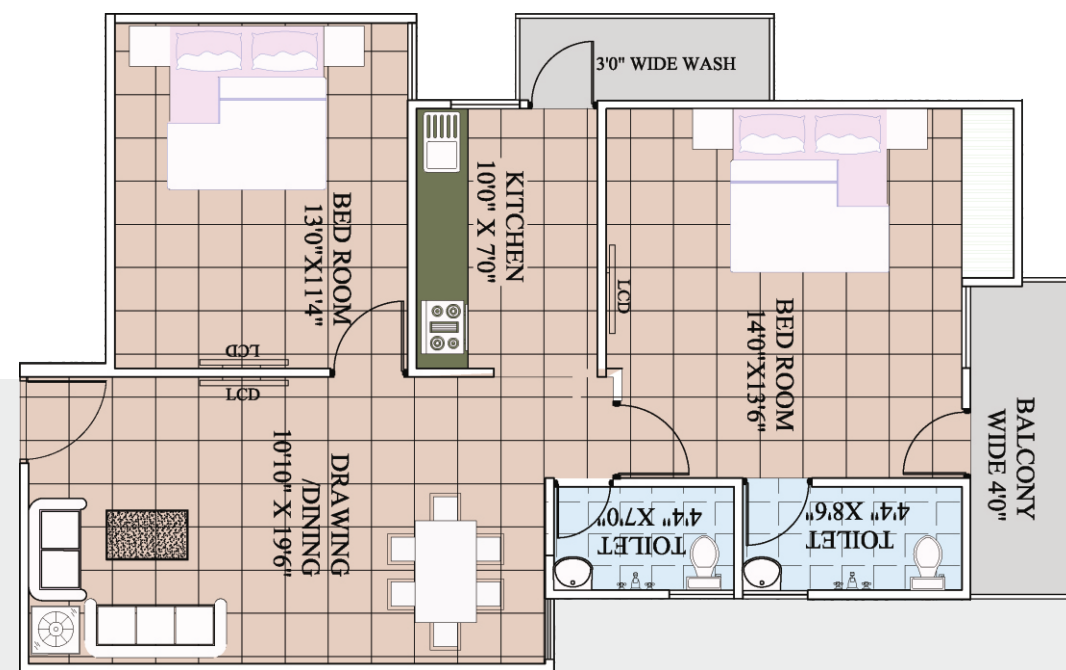
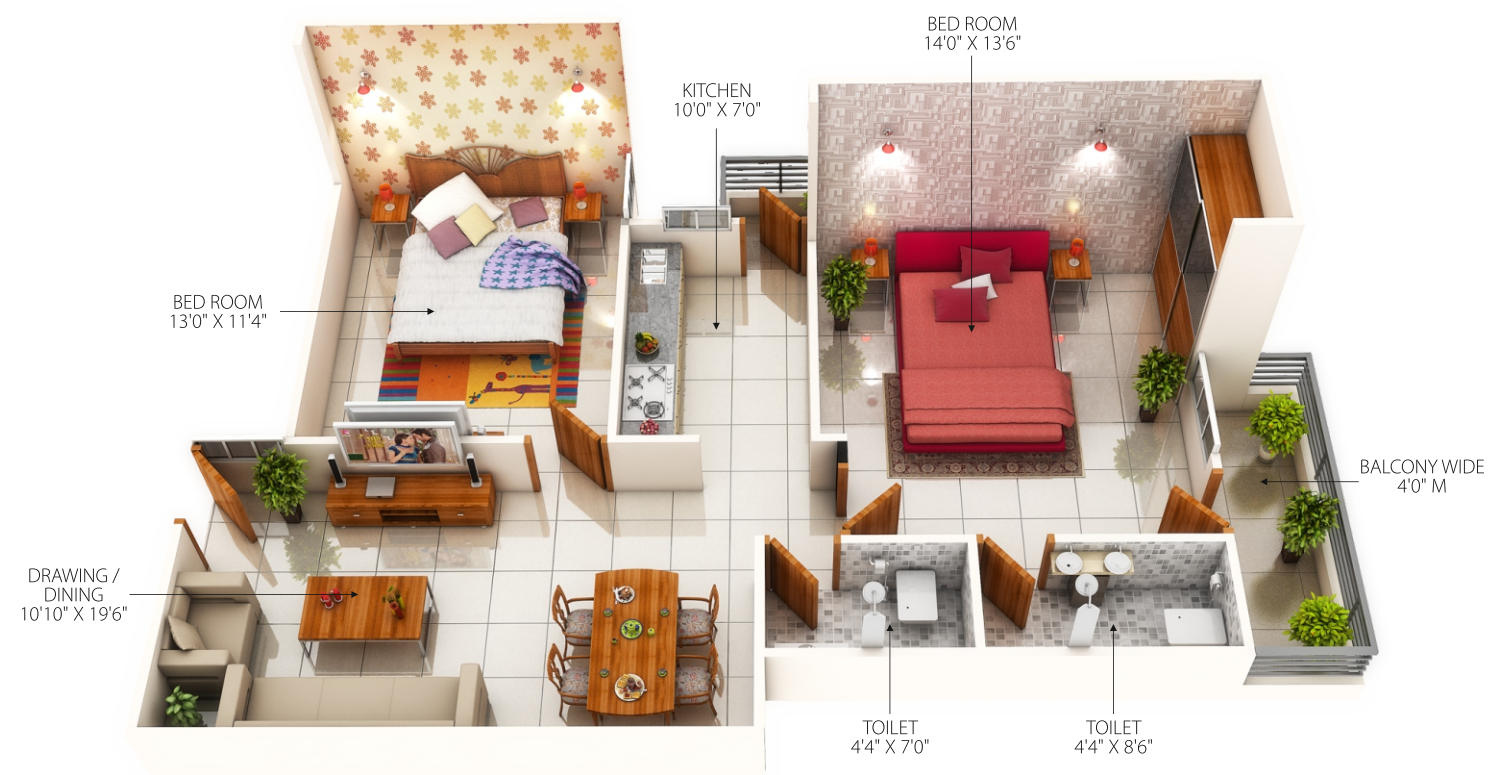

## 2 BHK Plan - SR. MIG

Super Built-up Area 1035 sqft.  
Built-up Area 765 sqft.

Set amidst lush greenery, nestled within a gated community Amaltas **Ambreen Homes** will usher a new concept of affordable luxury at Katara Hills, Near AIIMS, Hoshangabad Road, Bhopal. Amaltas **Ambreen Homes** is a dream envisioned by Amaltas to offer its residents the best of both worlds - city excitement and small-town tranquility. It has been conceived and designed with the purpose of creating a world-class living habitat that is a celebration of nature and a complete paradise in itself.

Amaltas **Ambreen Homes** being on Katara Hills, Bhopal is one of the ideal investment with prospect to future development and investment appreciation, the location has been specially chosen emphasizing on various aspects of connectivity & easy access to all destinations such as Habibganj Railway Station, schools, colleges, hospitals etc.

After the remarkable success of Golden Mile Phase-I & 2, we are presenting Amaltas **Ambreen Homes**. With this project we will offer you different types of Premium HIG & MIG flats. Each and every corner of the flat is best combination of ventilation, light & space.

The campus will provide you luxuries of modern living with utmost grace and splendour.





# Amaltas **AMBREEN** HOMES 2 & 3 BHK LUXURIOUS APARTMENTS



## Project Highlights

Amaltas **Ambreen Homes** is superbly designed project, offers you different types of beautiful apartments. Amaltas **Ambreen Homes** is situated at Katara Hills, Near AIIMS, Hoshangabad Road, Bhopal. Nationalised Banks, School, Petrol

Pump, Police Station, Public Transport, Restaurant & Market for shopping daily need goods are within 1 km range from the project.

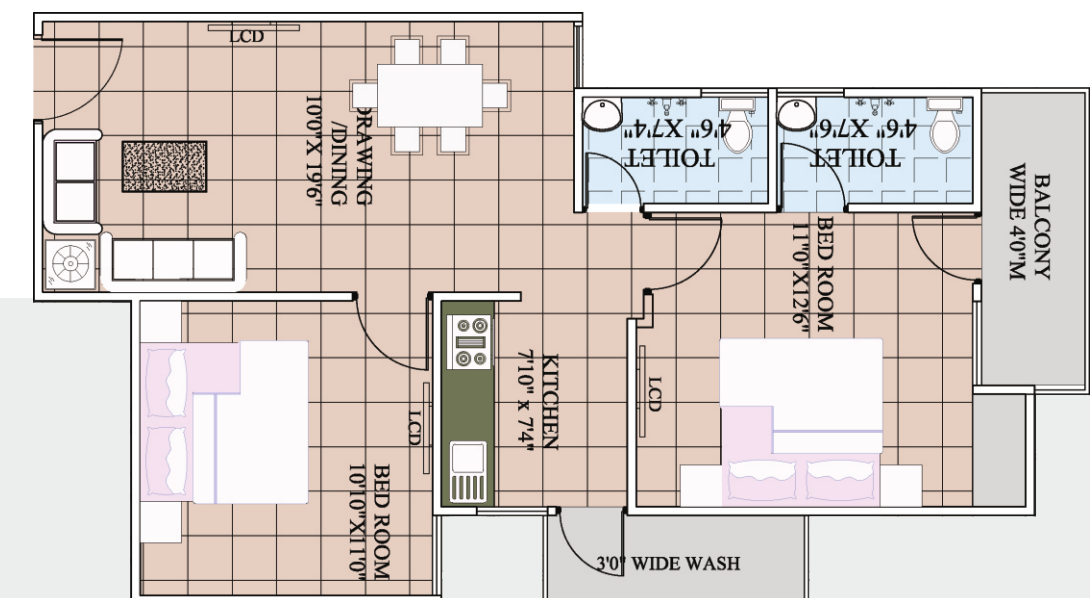

**2 BHK Plan - MIG**  
Super Built-up Area 865 sqft.  
Built-up Area 640 sqft.





## USP of Ambreen Homes

- ◆ Fully secured campus.
- ◆ Just 10 minutes from Habibganj Railway Station.
- ◆ Just 07 minutes from Inter State Bus Terminus (Bus Stand).
- ◆ Adjacent to proposed Intercity Metro Station.
- ◆ Adjacent to proposed ring road.
- ◆ Adjoining AIIMS, Barkatullah University, Jawahar School and other educational institutes.
- ◆ Public transport available.

## Specifications

- ◆ Earthquake resistant RCC structure
- ◆ Vitrified tiles flooring in all rooms
- ◆ Vitrified tiles in kitchen & anti-skid floor tiles in bathroom
- ◆ Bathroom wall tiles upto 7' height
- ◆ Sliding aluminum windows
- ◆ Green marble platform, modular kitchen (optional)
- ◆ Door shutters will be flush doors & main door will be decorative
- ◆ Concealed plumbing, Geyser points
- ◆ Concealed copper wiring with modular switches and AC points
- ◆ All internal walls shall be painted by emulsion with putty finish, weather proof paint on external walls
- ◆ Wash area with Washing machine electric point & water drain-off.